

RODAMIENTOS DE AGUJAS SEPARABLES CON ANILLO INTERIOR

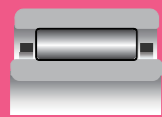

NAF



NAFW

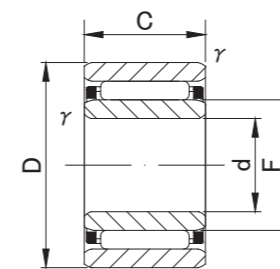

NAF

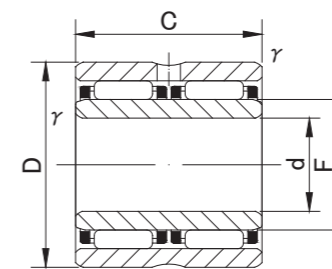

NAFW

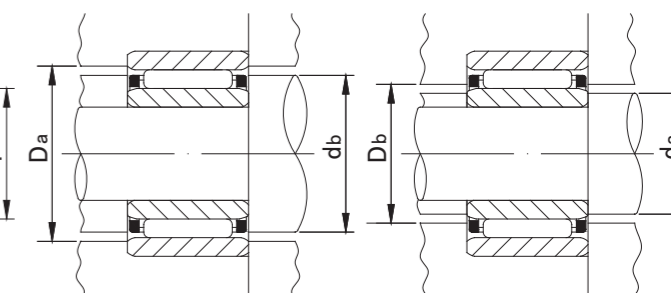

TIPO NAF(W)

Diámetro de eje (mm)	Designación	Dimensiones (mm)						Dimensiones de montaje estándar (mm)				Capacidad de carga dinámica básica	Capacidad de carga estática básica	Velocidad límite *	Masa (g (aprox.))	Designación de rodamiento utilizable					
		d	D	C	r/s mín.	F	db	Da MÁX.	da		Db					Cr N	Cor N	rpm	g	ANILLO EXTERIOR	ANILLO INTERIOR
									MÍN.	MÁX.											
6	NAF 61710	6 ⁰ _{-0.008}	17	10	0.3	10	12.4	15	8	9.7	10.4	4 100	4 500	28 000	14	RNAF101710	IR61010				
7	NAF 72012	7 ⁰ _{-0.008}	20	12	0.3	10	13.5	18	9	9.7	10.4	6 000	6 000	28 000	23	RNAF102012	IR71012				
9	NAF 92212	9 ⁰ _{-0.008}	22	12	0.3	12	17.5	20	11	11.5	12.4	9 000	8 400	26 000	24	RNAF122212	IR91212				
10	NAF 102213	10 ⁰ _{-0.008}	22	13	0.3	14	17.6	20	12	13	14.6	7 800	9 400	24 000	26	RNAF142213	IR101413				
	NAFW 102220	10 ⁰ _{-0.008}	22	20	0.3	14	17.6	20	12	13	14.6	10 800	14 200	24 000	40	RNAFW142220	IR101420				
	NAF 102612	10 ⁰ _{-0.008}	26	12	0.3	14	19.4	24	12	13	14.6	9 800	9 700	24 000	36	RNAF142612	IR101412				
12	NAF 122413	12 ⁰ _{-0.008}	24	13	0.3	16	19.6	22	14	15	16.6	8 600	11 000	23 000	30	RNAF162413	IR121613				
	NAFW 122420	12 ⁰ _{-0.008}	24	20	0.3	16	19.6	22	14	15	16.6	11 900	16 700	23 000	45	RNAFW162420	IR121620				
	NAF 122812	12 ⁰ _{-0.008}	28	12	0.3	16	21.4	26	14	15	16.6	10 500	10 900	23 000	40	RNAF162812	IR121612				
15	NAF 152813	15 ⁰ _{-0.008}	28	13	0.3	20	23.6	26	17	19	20.6	9 600	13 500	20 000	37	RNAF202813	IR152013				
	NAFW 152826	15 ⁰ _{-0.008}	28	26	0.3	20	23.6	26	17	19	20.6	16 500	27 100	20 000	76	RNAFW202826	IR152026				
	NAF 153212	15 ⁰ _{-0.008}	32	12	0.3	20	25.4	30	17	19	20.6	12 400	14 300	20 000	51	RNAF203212	IR152012				
17	NAF 173013	17 ⁰ _{-0.008}	30	13	0.3	22	25.6	28	19	21	22.6	10 200	15 200	18 000	43	RNAF223013	IR172213				
	NAFW 173026	17 ⁰ _{-0.008}	30	26	0.3	22	25.6	28	19	21	22.6	17 600	30 300	18 000	85	RNAFW223026	IR172226				
	NAF 173516	17 ⁰ _{-0.008}	35	16	0.3	22	27.8	33	19	21	22.6	17 600	20 900	18 000	77	RNAF223516	IR172216				
	NAFW 173532	17 ⁰ _{-0.008}	35	32	0.3	22	27.8	33	19	21	22.6	30 200	41 900	18 000	155	RNAFW223532	IR172232				
20	NAF 203517	20 ⁰ _{-0.010}	35	17	0.3	25	29.5	33	22	24	25.6	17 300	26 600	16 000	75	RNAF253517	IR202517				
	NAFW 203526	20 ⁰ _{-0.010}	35	26	0.3	25	29.5	33	22	24	25.6	22 500	37 200	16 000	114	RNAFW253526	IR202526				
	NAF 203716	20 ⁰ _{-0.010}	37	16	0.3	25	30.4	35	22	24	25.6	19 400	24 500	16 000	80	RNAF253716	IR202516				
	NAFW 203732	20 ⁰ _{-0.010}	37	32	0.3	25	30.4	35	22	24	25.6	33 200	49 000	16 000	158	RNAFW253732	IR202532				
25	NAF 254017	25 ⁰ _{-0.010}	40	17	0.3	30	34.5	38	27	29	30.6	18 600	31 100	13 000	88	RNAF304017	IR253017				
	NAFW 254026	25 ⁰ _{-0.010}	40	26	0.3	30	34.5	38	27	29	30.6	24 200	43 400	13 000	136	RNAFW304026	IR253026				
	NAF 254216	25 ⁰ _{-0.010}	42	16	0.3	30	35.4	40	27	29	30.6	20 800	28 300	13 000	94	RNAF304216	IR253016				
	NAFW 254232	25 ⁰ _{-0.010}	42	32	0.3	30	35.4	40	27	29	30.6	35 700	56 800	13 000	187	RNAFW304232	IR253032				
30	NAF 304517	30 ⁰ _{-0.010}	45	17	0.3	35	39.5	43	32	34	35.6	20 500	36 900	11 000	100	RNAF354517	IR303517				
	NAFW 304526	30 ⁰ _{-0.010}	45	26	0.3	35	39.5	43	32	34	35.6	26 600	51 600	11 000	155	RNAFW354526	IR303526				
	NAF 304716	30 ⁰ _{-0.010}	47	16	0.3	35	40.4	45	32	34	35.6	23 000	33 800	11 000	108	RNAF354716	IR303516				
	NAFW 304732	30 ⁰ _{-0.010}	47	32	0.3	35	40.4	45	32	34	35.6	39 500	67 800	11 000	215	RNAFW354732	IR303532				

* Ideal para lubricación con aceite. En caso de lubricación con grasa, reducción al 50 % de este valor.

RODAMIENTOS DE AGUJAS SEPARABLES CON ANILLO INTERIOR

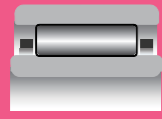

NAF



NAFW

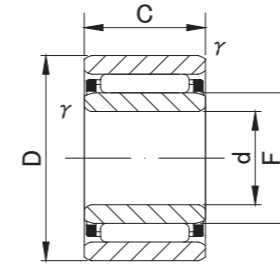

NAF

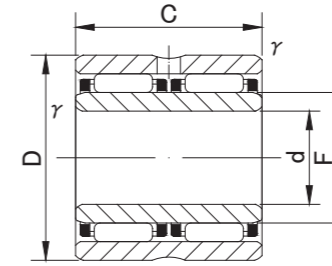

NAFW

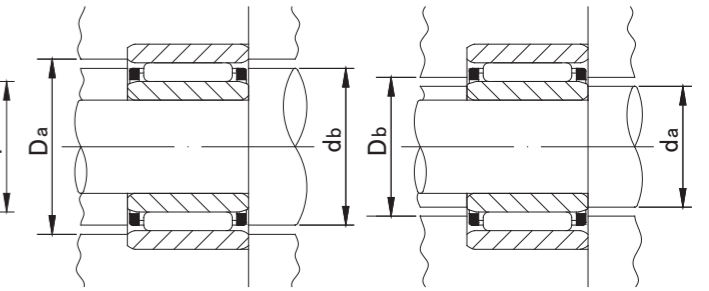

TIPO NAF(W)

Diámetro de eje (mm)	Designación	Dimensiones (mm)					Dimensiones de montaje estándar (mm)			Capacidad de carga dinámica básica	Capacidad de carga estática básica	Velocidad límite *	Masa	Designación de rodamiento utilizable							
		d	D	C	r/s mín.	F	db	Da MÁX.	da					Db	Cr N	Cor N	rpm	g (aprox.)	ANILLO EXTERIOR	ANILLO INTERIOR	
									MÍN.												MÁX.
35	NAF 355017	35	50	17	0.3	40	43.5	48	37	39	40.8	22 200	42 700	10 000	115	RNAF405017	IR354017				
	NAFW 355034	35 ₀	50	34	0.3	40	43.5	48	37	39	40.8	38 000	85 300	10 000	230	RNAFW405034	IR354034				
	NAF 355520	35 _{-0.012}	55	20	0.3	40	45.2	53	37	39	40.8	31 500	48 000	10 000	188	RNAF405520	IR354020				
	NAFW 355540	35	55	40	0.3	40	45.2	53	37	39	40.8	53 900	96 000	10 000	375	RNAFW405540	IR354040				
40	NAF 405517	40	55	17	0.3	45	48.5	53	42	44	45.8	23 200	47 200	10 000	129	RNAF455517	IR404517				
	NAFW 405534	40 ₀	55	34	0.3	45	48.5	53	42	44	45.8	39 900	94 200	10 000	255	RNAFW455534	IR404534				
	NAF 406220	40 _{-0.012}	62	20	0.3	45	50.9	60	42	44	45.8	33 200	53 300	9 000	236	RNAF456220	IR404520				
	NAFW 406240	40	62	40	0.3	45	50.9	60	42	44	45.8	57 000	106 900	9 000	475	RNAFW456240	IR404540				
45	NAF 456220	45	62	20	0.3	50	54.2	60	47	49	50.8	27 100	59 300	8 000	197	RNAF506220	IR455020				
	NAFW 456240	45 ₀	62	40	0.3	50	54.2	60	49	49.5	50.8	46 400	118 700	8 000	389	RNAFW506240	IR455040				
	NAF 457220	45 _{-0.012}	72	20	0.6	55	60.9	68	49	54	55.8	37 400	66 400	7 500	340	RNAF557220	IR455520				
	NAFW 457240	45	72	40	0.6	55	60.9	68	49	54	55.8	64 100	132 400	7 500	685	RNAFW557240	IR455540				
50	NAF 506820	50	68	20	0.6	55	59.5	64	54	54.5	55.8	28 500	66 000	7 500	230	RNAF556820	IR505520				
	NAFW 506840	50 ₀	68	40	0.6	55	59.5	64	54	54.5	55.8	48 900	132 400	7 500	465	RNAFW556840	IR505540				
	NAF 507820	50 _{-0.012}	78	20	1	60	66.3	73	55	59	60.8	38 900	71 700	6 500	390	RNAF607820	IR506020				
	NAFW 507840	50	78	40	1	60	66.3	73	55	59	60.8	66 700	143 200	6 500	775	RNAFW607840	IR506040				
55	NAF 558530	55 ₀	85	30	1	65	72	80	60	63	66	59 300	127 500	6 000	680	RNAF658530	IR556530				
	NAFW 558560	55 _{-0.015}	85	60	1	65	72	80	60	63	66	102 000	254 000	6 000	1 380	RNAFW658560	IR556560				
60	NAF 609030	60 ₀	90	30	1	70	77	85	65	68	71	61 200	135 300	5 500	740	RNAF709030	IR607030				
	NAFW 609060	60 _{-0.015}	90	60	1	70	77	85	65	68	71	104 900	271 600	5 500	1 470	RNAFW709060	IR607060				
65	NAF 659530	65 ₀	95	30	1	75	82	90	70	73	76	63 200	144 200	5 500	800	RNAF759530	IR657530				
	NAFW 659560	65 _{-0.015}	95	60	1	75	82	90	70	73	76	108 900	289 300	5 500	1 570	RNAFW759560	IR657560				
70	NAF 7010030	70 ₀	100	30	1	80	87	95	75	78	81	64 900	153 000	5 000	840	RNAF8010030	IR708030				
	NAFW 7010060	70 _{-0.015}	100	60	1	80	87	95	75	78	81	111 800	306 000	5 000	1 670	RNAFW8010060	IR708060				
75	NAF 7510530	75 ₀ -0.015	105	30	1	85	92	100	80	83	86	66 600	160 800	4 800	890	RNAF8510530	IR758530				
80	NAF 8011030	80 ₀ -0.015	110	30	1	90	97	105	85	88	91	69 500	173 600	4 500	930	RNAF9011030	IR809030				
85	NAF 8511530	85 ₀ -0.020	115	30	1	95	102	110	90	93	96	70 900	182 400	4 200	970	RNAF9511530	IR859530				
90	NAF 9012030	90 ₀ -0.020	120	30	1	100	107	115	95	98	101	72 600	191 200	4 000	1 040	RNAF10012030	IR9010030				

* Ideal para lubricación con aceite. En caso de lubricación con grasa, reducción al 50 % de este valor.